



X-LOCK CUT-OFF DISC

CHEMITOOL X-LOCK Stainless Steel Cut-Off guarantees great cutting performance, always with maximum safety. Indicated for professional work of thin cutting in stainless steel.

- ✓ **5x faster replacement**
- ✓ **Safe disc assembly**
- ✓ **Versatile**
- ✓ **High cutting performance**
- ✓ **Great stability and job safety**
- ✓ **Breaking resistance**
- ✓ **Long tool life**

CHEMITOOL X-LOCK Stainless Steel Cut-Off is composed of high quality Aluminium Oxide A with advanced phenolic resin, for more difficult applications always offering good cutting results.

Guarantees maximum stability and work safety, thanks to the precisely manufactured fiberglass mesh.

The X-LOCK system provides speed and ease of use thanks to its quick-change system that allows you to replace discs in just one click. The X format slot allows you to hold the disc on the angle grinder without using the clamping nut. Also, for use in a regular angle grinder.

Abrasive

Aluminium Oxide A

Suitable for

Stainless Steel, hard alloy steels, hardox, galvanized steel and non-ferrous metals

Suitable Machines

Angle Grinder



CHEMITOOL bonded discs comply with European Standards (EN 12413).

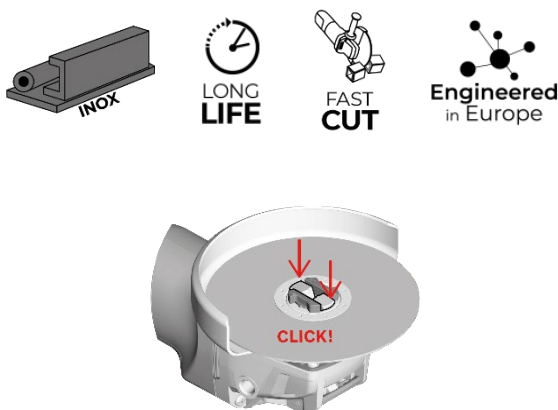

SAP	∅ (mm)	Bore Diameter (mm)	Thickness (mm)	R.P.M.	∅	EAN
CHA0110115100	115	22	1	13 300	25	5604630052665
CHA0110115160	115	22	1,6	13 300	25	5604630052672
CHA0110125100	125	22	1	12 200	25	5604630052689
CHA0110125160	125	22	1,6	12 200	25	5604630052696

Note: The technical information provided, either verbally or in writing, is based on our current knowledge and should be considered as collaboration without commitment. The use of the product is beyond our control, thus, we rule out any responsibility for its improper use. The customer is responsible to confirm and validate (by testing) if the product is suitable for the process and the type of use in question. Our purpose is exclusively to guarantee the quality of the products, according to our standards.

*X-LOCK is a patented accessory-change system by Bosch Professional®